

WARNING!!
 DO NOT CUT OR DAMAGE ZMESH. DO NOT ALLOW ZMESH TO COME INTO CONTACT WITH ANY OTHER ELECTRICALLY CONDUCTIVE MATERIAL. DO NOT FASTEN THROUGH ANY ELECTRICALLY CONDUCTIVE MATERIAL AND ZMESH SIMULTANEOUSLY.

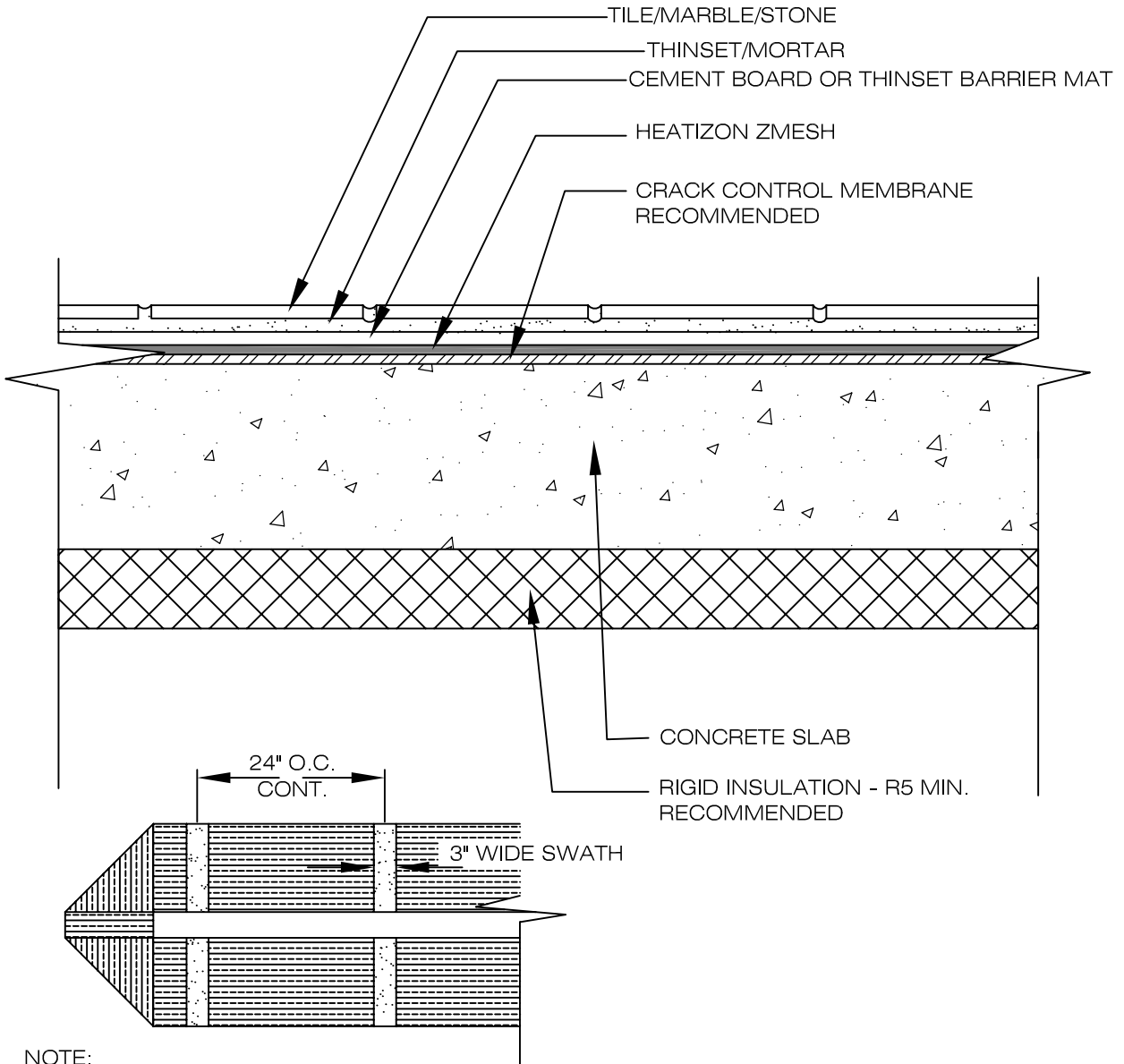

NOTE:
 IF INSTALLATION OF ZMESH IS ON CONCRETE, USE A FLOORING ADHESIVE TO HOLD THE ZMESH IN PLACE. PLACE 3" WIDE SWATHS OF ADHESIVE ACROSS THE ZMESH.

DRAWING NO.:

FH-5

**ZMESH UNDER TILE/STONE
 ON CONCRETE SLAB**

DRAWING BY:

RJB

DATE:

DEC 2012

HEATIZON SYSTEMS

advanced floor heating/ snow and ice removal systems

4137 SOUTH 500 WEST, MURRAY, UTAH 84123 PH (801) 293-1232 FAX (801) 293-3077

©2009